

**COLLAPSIBLE MOBILE LEADED BARRIER
WITH 24" X 28" WINDOW**

PRODUCT INFORMATION

PHILLIPS-SAFETY.COM

COPYRIGHT ©2025. ALL RIGHTS RESERVED



PHILLIPS SAFETY
PRODUCTS INC.

PRODUCT INFORMATION
COLLAPSIBLE MOBILE LEADED BARRIER WITH 24" X 28" WINDOW



The Collapsible Mobile Leaded Barrier with 24.25" x 28.5" Window is a portable full-body radiation barrier for protection against secondary radiation. It travels easily on four locking casters and features a screen that can be easily raised and lowered by hand. This Phillips Safety radiation barrier has a 0.50mm lead equivalent lightweight leaded acrylic window and a 2.0mm lead equivalent steel and lead frame. Its overall size is 30.5"W and 74.5" to 75"H, accommodating slight sizing fluctuations.

SPECIFICATION

BARRIER MATERIAL: Metal	WINDOW MATERIAL: Acrylic
OVERALL SIZE: 30.5"W and 74.5" to 75"H	WINDOW PROTECTION LEVEL: 0.5mm PbEq
PROTECTION LEVEL: 2.0mm PbEq	WINDOW SIZE: 24.5" x 28.5"
FEATURES: Lead window, Four locking casters, Adjustable height	

PRODUCT INFORMATION
COLLAPSIBLE MOBILE LEADED BARRIER WITH 24" X 28" WINDOW

COLLAPSIBLE MOBILE BARRIER

EXPANDED IMAGE

FRONT

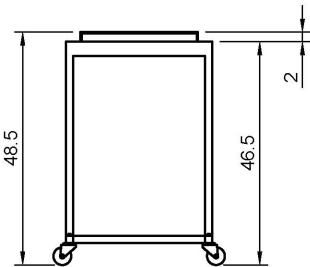

SIDE

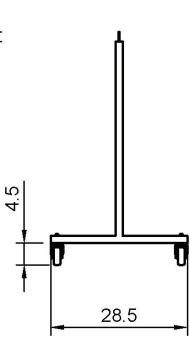

TOP

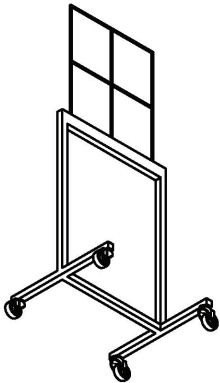
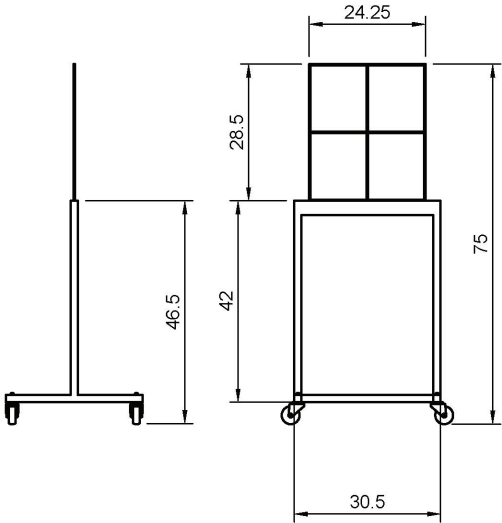
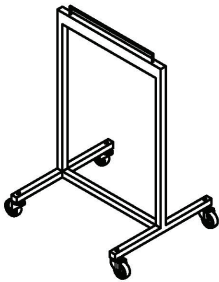
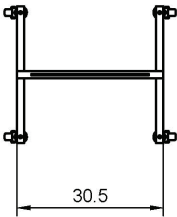

Linear Dimensions	Angular Dimensions	PROJECT			
X.X ± 0.01	± 0.05	LB-7429			
X.XX ± 0.005		TITLE			
X.XXX ± 0.005					
General Tolerance Table		CREATED FOR: PHILLIPS-SAFETY			
APPROVED:		SIZE	CODE	DWG NO	REV
CHECKED:		A3			
CREATED: Jerry Verden / etx3d.com		1/14/2025		SCALE 1:20	

PRODUCT INFORMATION

COLLAPSIBLE MOBILE LEADED BARRIER WITH 24" X 28" WINDOW

CONTACT

Should you need any further information,
please do not hesitate to contact us.

123 Lincoln Blvd, Middlesex, NJ 08846, USA



+1 866 575 1307



service@phillips-safety.com



www.phillips-safety.com



PHILLIPS SAFETY
PRODUCTS INC.

PHILLIPS-SAFETY.COM